

# Inductive sensor

## NCB1,5-8GM40-N0-V1-Y97264

- Comfort series
- 1.5 mm flush



### Dimensions

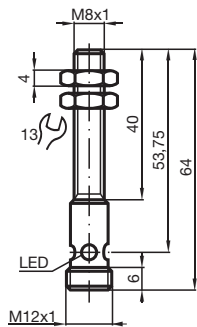

### Technical Data

#### General specifications

Switching function		Normally closed (NC)
Output type		NAMUR
Rated operating distance	$s_n$	1.5 mm
Installation		flush
Assured operating distance	$s_a$	0 ... 1.215 mm
Actual operating distance	$s_r$	1.35 ... 1.65 mm typ.
Reduction factor $r_{Al}$		0.22
Reduction factor $r_{Cu}$		0.19
Reduction factor $r_{304}$		0.65
Output type		2-wire

#### Nominal ratings

Nominal voltage	$U_o$	8.2 V ( $R_i$ approx. 1 k $\Omega$ )
Switching frequency	$f$	0 ... 5000 Hz
Hysteresis	$H$	1 ... 10 typ. 3 %
Reverse polarity protection		reverse polarity protected
Short-circuit protection		yes
Current consumption		
Measuring plate not detected		min. 3 mA
Measuring plate detected		$\leq$ 1 mA

Release date: 2023-01-26 Date of issue: 2023-01-26 Filename: 70133336\_eng.pdf

Refer to "General Notes Relating to Pepperl+Fuchs Product Information".

Pepperl+Fuchs Group  
www.pepperl-fuchs.com

USA: +1 330 486 0001  
fa-info@us.pepperl-fuchs.com

Germany: +49 621 776 1111  
fa-info@de.pepperl-fuchs.com

Singapore: +65 6779 9091  
fa-info@sg.pepperl-fuchs.com

PEPPERL+FUCHS

## Technical Data

Switching state indicator	Multihole-LED, yellow
<b>Compliance with standards and directives</b>	
Standard conformity	
NAMUR	EN 60947-5-6:2000 IEC 60947-5-6:1999
Electromagnetic compatibility	NE 21:2007
Standards	EN 60947-5-2:2007 EN 60947-5-2/A1:2012 IEC 60947-5-2:2007 IEC 60947-5-2 AMD 1:2012
<b>Approvals and certificates</b>	
IECEX approval	
Equipment protection level Ga	IECEX PTB 11.0037X
Equipment protection level Gb	IECEX PTB 11.0037X
Equipment protection level Da	IECEX PTB 11.0037X
Equipment protection level Mb	IECEX PTB 11.0037X
ATEX approval	
Equipment protection level Ga	PTB 00 ATEX 2048 X
Equipment protection level Gb	PTB 00 ATEX 2048 X
Equipment protection level Da	PTB 00 ATEX 2048 X
UL approval	
Ordinary Location	E87056
Hazardous Location	E501628
Control drawing	116-0452
<b>Ambient conditions</b>	
Ambient temperature	-25 ... 100 °C (-13 ... 212 °F)
Storage temperature	-40 ... 100 °C (-40 ... 212 °F)
<b>Mechanical specifications</b>	
Connection type	Connector plug
Housing material	brass, nickel-plated
Sensing face	PBT
Degree of protection	IP67
Connector	
Threading	M12 x 1
Number of pins	4
<b>General information</b>	
Use in the hazardous area	see instruction manuals

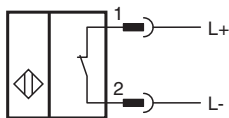

## Connection



Wire colors in accordance with EN 60947-5-6

1		BN	(brown)
2		BU	(blue)

## Accessories

	<b>KCD2-E2L</b>	Sensor output interface terminal with lead breakage monitoring
	<b>V1-W-N-2M-PUR</b>	Female cordset single-ended M12 angled A-coded, 2-pin, PUR cable blue, NAMUR
	<b>V1-G-N-2M-PUR</b>	Female cordset single-ended M12 straight A-coded, 2-pin, PUR cable blue, NAMUR

Release date: 2023-01-26 Date of issue: 2023-01-26 Filename: 70133336\_eng.pdf

Refer to "General Notes Relating to Pepperl+Fuchs Product Information".